

YAMAHA COMBO SYNTHESIZER

CS-30

PARTS LIST

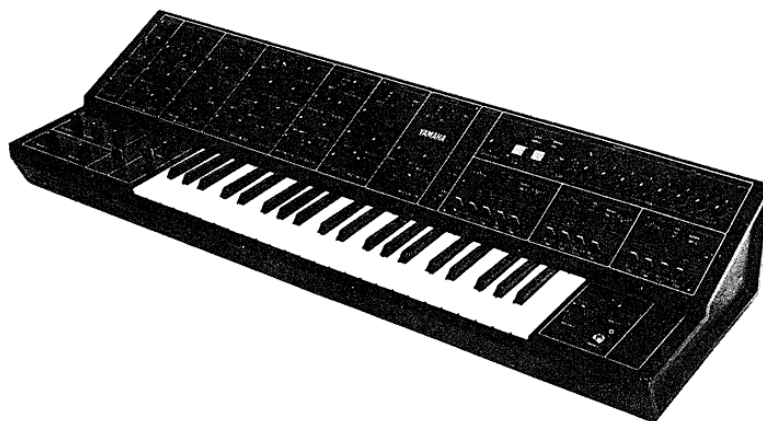

INDEX (目次)

Circuit Boards & Components (シート及びシート部品)	2
Keyboard, Panel & Components (鍵盤及びパネル部品)	5
Cabinet (外装部品)	7

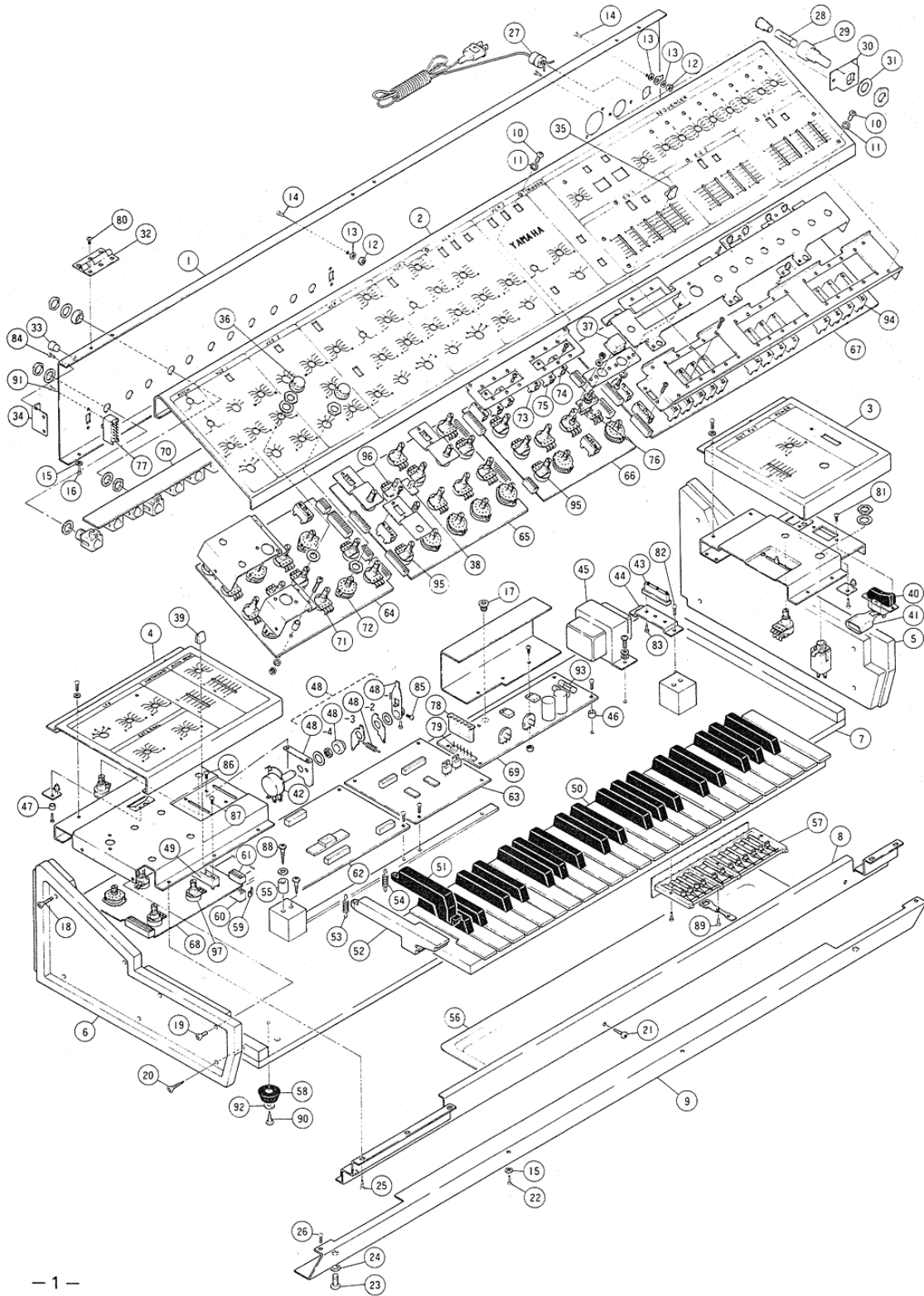

1. Circuit Boards & Components(シート及びシート部品)

Ref. No.	Part No.	Description (部品名)	Remarks	Common Model
62	30:12:47:NA:80:28:80	SSK circuit board #82580	S S K シ ー ト	CS-30L
64	30:12:47:NA:80:28:90	VCO - do. - #82590	V C O シ ー ト	
65	30:12:47:NA:80:29:00	VCF - do. - #82600	V C F シ ー ト	
66	30:12:47:NA:80:29:10	VCA - do. - #82610	V C A シ ー ト	
63	30:12:47:NA:80:29:20	PRA - do. - #82620	P R A シ ー ト	CS-30L
67	30:12:47:NA:80:29:30	SEQ - do. - #82630	S E Q シ ー ト	
68	30:12:47:NA:80:29:40	LFO - do. - #82641	L F O シ ー ト	
70	30:12:00:NA:80:29:50	JK - do. - #82650	J K シ ー ト	
69	30:12:00:NA:80:29:60	ADC - do. - #82640	A D C シ ー ト	CS-30L
	30:12:00:NA:80:29:70	- do. - - do. - - do. -	"	N. European British - do. -
	30:12:00:NA:80:36:40	- do. - - do. - - do. -	"	Japan - do. -
	30:10:00:YM:24:80:00	IC YM24800	I C	SSK
	40:10:00:iG:00:10:20	- do. - HA1452	"	OP-Amp
	40:10:00:iG:00:12:40	- do. - TC4011	"	NAND
	40:10:00:iG:00:12:60	- do. - TC4049	"	Inverter
	40:10:00:iG:00:13:90	- do. - NJM4558	"	OP-Amp
	40:10:00:iG:00:15:00	- do. - IG00150	"	VCOII
	40:10:00:iG:00:15:10	- do. - IG00151	"	VCA
	40:10:00:iG:00:15:20	- do. - IG00152	"	EG-VCF
	40:10:00:iG:00:15:30	- do. - IG00153	"	VCOIII
	40:10:00:iG:00:15:60	- do. - IG00156	"	VCF
	40:10:00:iG:00:15:80	- do. - IG00158	"	WSC
	40:10:00:iG:00:15:90	- do. - IG00159	"	EG-VCA
	40:10:00:iG:00:16:00	- do. - BA634	"	Divider
	40:10:00:iG:00:16:20	- do. - μ A796HC	"	Ring-MOD
	40:10:00:iG:00:16:90	- do. - TC4016P	"	Gate
	40:10:00:iG:00:17:20	- do. - TC4069P	"	Inverter
	40:10:00:iG:02:55:00	- do. - TA7504S	"	OP-Amp
	40:10:00:iG:02:56:00	- do. - TA7505	"	OP-Amp
	40:10:00:iG:02:75:00	- do. - TC4022P	"	8 step counter
	40:10:00:iA:04:90:10	Transistor 2SA490	ト ラ ン ジ ス タ	
	40:10:00:iA:05:61:70	- do. - 2SA561	"	
	40:10:00:iC:04:58:50	- do. - 2SC458	"	
	40:10:00:iC:05:09:20	- do. - 2SC509	"	
	40:10:00:iD:02:35:10	- do. - 2SD235	"	
	40:10:00:iE:00:00:10	FET 2SK30A	F E T	
	40:10:00:iF:00:00:10	Diode 1N34A	ダ イ オ ー ド	
	40:10:00:iF:00:00:40	- do. - 1S1555	"	
	40:10:00:iF:00:03:00	- do. - 1S1715P	"	
	40:10:00:iH:00:01:40	- do. - 10DC-4	"	Substitution of 10DC-1
	40:10:00:iH:00:01:50	- do. - 10DC-4R	"	- do. - of 10DC-1R
	40:10:00:iH:00:05:90	- do. - 10E-1	"	
	40:10:00:iF:00:04:20	Zener Diode 02Z5.6A	ツェナーダイオード	
	40:10:00:iF:00:07:80	- do. - WZ150	"	
	40:10:00:iF:00:09:90	- do. - 02Z7.5A	"	
	40:10:00:iF:00:06:80	Light Emittted Diode SLP132B	発 光 ダイ オ ー ド	

Ref. No.	Part No.	Description (部 品 名)	Remarks	Common Model
40:10:00	iK:00:01:10	Photo Coupler P588-G50-201B	フォトカプラー	
40:10:00	FF:04:31:20	Polystyrene Capacitor 1,200PF	スチロールコンデンサ	
40:10:00	FC:08:54:70	Mylar Capacitor 100V 0.47 μ F	マイラーコンデンサ	
40:10:00	FM:09:71:00	Nonpolar Capacitor 16V 10 μ F	N P コンデンサ	
40:10:00	FP:14:61:00	Tantalum Capacitor 25V 1 μ F	タンタルコンデンサ	
40:10:00	FP:15:53:30	- do. - 35V 0.33 μ F	"	
40:10:00	FP:15:56:80	- do. - - do. - 0.68 μ F	"	
40:10:00	Hu:19:51:00	Metal Film Resistor 0.1% 100 Ω	金属被膜抵抗	
40:10:00	Hu:19:61:00	- do. - - do. - 1 K Ω	"	
40:10:00	Hu:19:62:00	- do. - - do. - 2 K Ω	"	
40:10:00	Hu:19:65:00	- do. - - do. - 5 K Ω	"	
40:10:00	Hu:19:71:00	- do. - - do. - 10 K Ω	"	
40:10:00	Hu:19:72:00	- do. - - do. - 20 K Ω	"	
40:10:00	Hu:19:74:00	- do. - - do. - 40 K Ω	"	
40:10:00	Hu:19:78:00	- do. - - do. - 80 K Ω	"	
40:10:00	Hu:19:81:00	- do. - - do. - 100 K Ω	"	
40:10:00	Hu:19:81:60	- do. - - do. - 160 K Ω	"	
40:10:00	HZ:00:08:60	- do. - - do. - 29.94 K Ω	"	
40:10:00	HZ:00:08:80	- do. - - do. - 1.684 K Ω	"	
40:10:00	Hu:57:53:30	- do. - 1% 330 Ω	"	
40:10:00	Hu:57:59:10	- do. - - do. - 910 Ω	"	
40:10:00	Hu:57:61:00	- do. - - do. - 1 K Ω	"	
40:10:00	Hu:57:62:00	- do. - - do. - 2 K Ω	"	
40:10:00	Hu:57:65:10	- do. - - do. - 5.1 K Ω	"	
40:10:00	Hu:57:68:20	- do. - - do. - 8.2 K Ω	"	
40:10:00	Hu:57:71:00	- do. - - do. - 10 K Ω	"	
40:10:00	Hu:57:71:80	- do. - - do. - 18 K Ω	"	
40:10:00	Hu:57:72:20	- do. - - do. - 22 K Ω	"	
40:10:00	Hu:57:81:00	- do. - - do. - 100 K Ω	"	
40:10:00	HL:31:24:70	Metal oxide Film Resistor 1W 0.47 Ω	酸化金属被膜抵抗	
40:10:00	HL:32:34:70	- do. - 2W 4.7 Ω	"	
40:10:00	HL:32:41:00	- do. - 2W 10 Ω	"	
40:10:00	Hi:20:99:90	Solid Resistor 10M Ω	ソリッド抵抗	
40:10:00	HT:37:01:50	Semi Variable Resistor B-100 Ω	半固定抵抗	V8K-4-1 type
40:10:00	HT:37:01:60	- do. - B-200 Ω	"	- do. -
40:10:00	HT:37:00:10	- do. - B-1K Ω	"	- do. -
40:10:00	HT:37:00:20	- do. - B-10K Ω	"	- do. -
40:10:00	HT:37:01:00	- do. - B-50K Ω	"	- do. -
40:10:00	HT:37:00:30	- do. - B-100K Ω	"	- do. -
40:10:00	HT:37:01:10	- do. - B-200K Ω	"	- do. -
40:10:00	HT:37:01:30	- do. - B-500K Ω	"	- do. -
40:10:00	HT:37:01:40	- do. - B-1M Ω	"	- do. -
40:10:00	HT:14:01:70	- do. - B-2 K Ω	"	V18K type
40:10:00	HT:55:00:60	- do. - B-5 K Ω	"	3006P type

Ref. No.	Part No.	Description (部品名)	Remarks	Common Model		
71	40:10:00:HS:31:01:70	Variable Resistor B-10 K Ω	可変抵抗器			
95	40:10:00:HS:31:02:00	- do. - A-50 K Ω	"			
96	40:10:00:HS:31:02:10	- do. - B-10K Ω c.c	"	KBD-Follow		
97	40:10:00:HS:31:02:50	- do. - A-100 K Ω	"	EXT-LEVEL		
94	40:10:00:HQ:42:00:30	Slide Variable Resistor B-10 K Ω	スライド可変抵抗器			
72	40:10:00:KA:50:10:90	Rotary Switch 5 contacts	ロータリSW 5接点			
	40:10:00:KA:50:10:80	- do. - 6 contacts	" 6接点			
73	40:10:00:KA:40:03:60	Slide Switch 3 contacts	スライドSW 3接点			
74	40:10:00:KA:40:05:70	- do. - 2 contacts	" 2接点			
75	40:10:00:KA:40:05:90	- do. - 3 contacts	" 3接点			
76	40:10:00:KA:70:09:50	Push Switch	プッシュSW	SEQ-START		
	40:10:00:LB:20:08:60	Phone Jack MONO	ジャックモノラル			
	40:10:00:LB:20:12:90	- do. - STEREO	" ステレオ			
93	40:10:00:KB:00:02:20	Fuse 125V 1.5A	ヒューズ	Japan		
	40:10:00:KB:00:07:40	- do. - miniature type 250V 1.6AT	"	European, British North European		
	40:10:00:KB:00:15:90	- do. - Approved by UL 150V 1.5A	"	others		
61	40:10:00:LB:60:20:70	Connector 7 pin	コネクタ 7 P	Bottom Entry		
	40:10:00:LB:60:20:80	- do. - 10 pin	" 10 P	- do. -		
	40:10:00:LB:60:19:60	- do. - 13 pin	" 13 P	- do. -		
	40:10:00:LB:60:20:90	- do. - 15 pin	" 15 P	- do. -		
	40:10:00:LB:60:15:00	Connector 7 pin	コネクタ 7 P	Top Entry		
	40:10:00:LB:60:03:00	- do. - 13 pin	" 13 P	- do. -		
	40:10:00:LB:60:20:60	- do. - 15 pin	" 15 P	- do. -		
59	40:10:00:LB:10:01:90	Connector Pin	コネクタピン			
60	40:10:00:LB:60:14:10	Connector Housing 7 Pin	ハウジング 7 P			
	40:10:00:LB:60:20:20	- do. - 10 Pin	" 10 P			
	40:10:00:LB:60:03:20	- do. - 13 Pin	" 13 P			
	40:10:00:LB:60:20:30	- do. - 15 Pin	" 15 P			
78	40:10:00:LB:60:14:00	Connector Housing 6 Pin	6 Pコネクタハウス	ADC CKT		
79	40:10:00:LB:60:13:80	Connector 6 Pin	6 Pコネクタ	- do. -		
	40:10:00:LB:60:13:90	Connector Pin	ピン	- do. -		

2. Keyboard, Panel & Components(鍵盤及びパネル部品)

Ref. No.	Part No.	Description (部品名)	Remarks	Common Model
50	30:12:47:NB:80:78:90	Keyboard Assembly	鍵盤 Ass'y	
57	30:12:47:NB:80:78:80	Switch Assembly 1U	スイッチ Ass'y	
	30:12:46:NB:80:77:90	- do. - 2, 3, 4U	"	
52	30:10:00:CB:01:11:70	White Key C, F	白 鍵	
	30:10:00:CB:01:11:80	- do. - D	"	
	30:10:00:CB:01:11:90	- do. - B, E	"	
	30:10:00:CB:01:12:00	- do. - G	"	
	30:10:00:CB:01:12:10	- do. - A	"	
	30:10:00:CB:01:12:20	- do. - C'	"	
51	30:10:00:CB:01:12:30	Black Key	黒 鍵	
53	30:10:00:AA:01:56:70	Key Spring for White Key	キースプリング	
54	30:10:00:AA:01:56:80	- do. - for Black Key	"	
35	30:10:00:CB:81:12:90	Knob for Slide VR	つまみ	
36	30:10:00:CB:81:01:30	- do. - for Rotary VR	"	
37	30:10:00:CB:81:03:90	- do. - for Push SW	"	
38	30:54:00:CB:80:52:30	- do. - for Slide SW	"	
39	30:10:00:CB:81:12:80	- do. - for Slide VR	"	PITCH BEND PORTAMENTO
77	40:10:00:KA:40:02:50	Slide Switch	スライド SW	-20/0 OUTPUT High/Low
	40:10:00:HS:31:02:40	Variable Resistor A-50 K Ω x 2	可変抵抗器	VOLUME
	40:10:00:HS:31:03:00	- do. - C-50 K Ω	"	LIMITTER
42	40:10:00:HS:42:02:70	- do. - W-50 K Ω	"	PITCH BEND
49	40:10:00:HQ:42:00:40	Slide Variable Resistor A-2M Ω	スライド VR	PORTAMENTO
	40:10:00:HQ:42:00:50	- do. - MN-10 K Ω	"	BALANCE
28	40:10:00:KB:00:06:60	Fuse 250V 400 mA T	ヒューズ	N.European British
	40:10:00:KB:00:11:50	- do. - 0.5 AT	"	Australian
	40:10:00:KB:00:10:60	- do. - 1 A	"	others
	40:10:00:KB:00:02:10	- do. - 125V 1 AT	"	Japan
29	40:10:00:LB:20:04:90	Fuse Holder	ヒューズホルダー	
	40:10:00:LB:20:05:90	- do. -	"	British, North European
	40:10:00:LB:20:02:50	Voltage Selector	電圧切替器	General, S.African British, N.European
45	40:10:00:GA:80:66:00	Power Transformer	電源トランス	Japan, US.American, Canadian
	30:12:00:NB:80:80:50	Power Transformer Unit with Connector	電源トランスユニット	others
40	40:10:00:KA:10:05:50	Power Switch	パワースイッチ	Japan, US.American Canadian
	40:10:00:KA:10:05:60	- do. -	"	others
41	40:10:00:FZ:00:09:50	Spark Suppressor Capacitor 250V 0.033 + 120	スパークキラー	Canadian
	40:10:00:FZ:00:01:10	- do. - 125V 0.033 + 120	"	Japan, US.American
	40:10:00:FQ:02:44:70	- do. - oil capacitor 630V 0.047 μ	"	GENERAL, S.African
27	40:10:00:CB:07:27:50	Bush for Cord	コードブッシュ	Japan
	40:10:00:CB:81:12:30	- do. -	"	US.American Canadian
	40:10:00:CB:07:06:90	- do. -	"	others

Ref. No.	Part No.	Description (部 品 名)	Remarks	Common Model
46	30:56:00:CB:01:09:80	Spacer for ADC Circuit board	シートスペーサー	
47	30:10:00:CB:02:67:10	Spacer for LED	LEDスペーサー	
55	30:10:00:CB:00:65:40	Keyboard Stopper	鍵盤回転止め	
56	30:10:00:CB:01:64:60	Dust Cover	ダストカバー	C-10
30	30:10:00:AA:80:64:40	Metal Fuse Holder	ヒューズホルダー金具	
31	40:10:00:AA:03:15:80	Fuse Holder Washer	ヒューズホルダーワッシャー	
32	30:10:00:AA:80:72:60	Hinge	蝶番	
33	30:10:00:CB:81:03:70	Stopper Rubber	ストッパーゴム	
34	30:10:00:AA:80:59:90	Angle	アングル	
43	40:10:00:LA:00:10:00	Terminal	カラー端子板	
44	30:10:00:AA:80:58:30	Terminal holder	端子板金具	
48	30:12:00:NB:80:75:90	Pitch Bend Assembly	ピッチベンド Ass'y	
48-1	30:10:00:AA:80:56:20	Lever	レバー	
48-2	30:10:00:AA:80:56:50	Coil Spring	コイルスプリング	
48-3	30:10:00:CB:81:01:40	Bush	ブッシュ	
48-4	30:10:00:AA:80:56:40	Frame	フレーム	
80	40:10:00:EB:03:00:50	Flat Head Screw M3 x 5	サラ小ネジ	
81	40:10:00:EA:03:00:60	Pan Head Screw M3 x 6	ナベ小ネジ	
82	40:10:00:EQ:03:11:00	Round Head Wood Screw M3.1 x 10	丸木ネジ	
83	40:10:00:EA:03:00:50	Pan Head Screw M3 x 5	ナベ小ネジ	
84	40:10:00:EG:33:01:00	Oval Pan Head Screw M3 x 10	尖先ナベ小ネジ	
85	40:10:00:EG:03:00:50	- do. - M3 x 5	"	
86	40:10:00:EA:02:60:60	Pan Head Screw M2.6 x 6	ナベ小ネジ	
87	40:10:00:EA:02:00:40	- do. - M2 x 4	"	
88	40:10:00:EQ:03:11:60	Round Head Wood Screw M3.1 x 16	丸木ネジ	
89	40:10:00:EA:03:01:00	Pan Head Screw M3 x 10	ナベ小ネジ	
91	40:10:00:EA:32:60:50	- do. - M2.6 x 5	"	

3. Cabinet (外装部品)

Ref. No.	Part No.	Description (部 品 名)	Remarks	Common Model
1	30:10:00:AA:80:58:80	Rear Panel	リヤ ー パネル	Japan
	30:10:00:AA:80:58:90	- do. -	"	others
	30:10:00:AA:80:59:00	- do. -	"	Canadian, US, American
2	30:10:00:AA:80:59:10	Control Panel	コントロールパネル	
3	30:10:00:AA:80:60:40	End Block Right	柏 子 木 (右)	
4	30:10:00:AA:80:60:50	- do. - Left	" (左)	
5	30:10:00:CB:81:04:40	Side Board Left	側 板 (左)	
6	30:10:00:CB:81:04:50	- do. - Right	" (右)	
7		Bottom Board	底 板	
8	30:10:00:AA:80:58:70	Key Board Spacer	口 金	
9	30:10:00:AA:80:61:30	Front Panel	口 板	
10	40:10:00:EC:33:00:60	Truss Head Screw M3 x 6	ト ラ ス 小 ネ ジ	
11	40:10:00:EV:20:00:30	Flat Washer 3S	平 座 金	
12	40:10:00:EV:10:00:40	Hexagonal Nut M4	六 角 ナ ッ ト	
13	40:10:00:EV:41:00:40	Toothed Lock Washer A4S	歯 付 座 金	
14	40:10:00:EA:34:01:00	Pan Head Screw M4 x 10	ナ ベ 小 ネ ジ	
15	40:10:00:EV:41:00:30	Toothed Lock Washer A3S	歯 付 座 金	
16	40:10:00:EG:33:01:00	Oval Pan Head Screw M3 x 10	尖 先 ナ ベ 小 ネ ジ	
17	40:10:00:EW:03:00:80	Gaff Nut with Frange M3 x 8	ツ バ 付 鬼 目 ナ ッ ト	
18	40:10:00:EG:04:01:80	Oval Bind Head Screw M4 x 18	尖 先 バ イ ン ド 小 ネ ジ	
19	40:10:00:EG:04:01:00	- do. - M4 x 10	"	
20	40:10:00:Ei:34:02:50	Bind Head Tapping Screw M4 x 25	バ イ ン ド タ ッ ピ ン ネ ジ	
21	40:10:00:Ei:04:00:80	- do. - M4 x 8	"	
22	40:10:00:EQ:33:11:00	Round Head Wood Screw M3.1 x 10	丸 木 ネ ジ	
23	40:10:00:EG:05:02:00	Oval Pan Head Screw M5 x 20	尖 先 ナ ベ 小 ネ ジ	
24	40:10:00:EV:41:00:50	Toothed Lock Washer A5S	歯 付 座 金	
25	40:10:00:Ei:03:00:60	Bind Head Tapping Screw M3 x 6	バ イ ン ド タ ッ ピ ン ネ ジ	
26	40:10:00:Ei:03:00:80	- do. - M3 x 8	"	
58	30:54:00:CB:80:12:70	Yielding Rubber	ゴ ム 脚	
90	40:10:00:EQ:33:51:30	Round Head Wood Screw M3.5 x 13	丸 木 ネ ジ	
92	40:10:00:EV:20:00:40	Flat Washer 4S	平 座 金	